



# VESTIL MANUFACTURING CORP.

2999 North Wayne Street, P.O. Box 507, Angola, IN 46703  
Telephone: (260) 665-7586 -or- Toll Free (800) 348-0868  
Fax: (260) 665-1339  
URL: [www.vestilmfg.com](http://www.vestilmfg.com) email: [info@vestil.com](mailto:info@vestil.com)

## BOL-R Series Removable Bollards



### Receiving Instructions

After delivery, remove the packaging from the product. Inspect the product closely to determine whether it sustained damage during transport. If damage is discovered, record a complete description of it on the bill of lading. If the product is undamaged, discard the packaging.

**NOTE:** The end-user is solely responsible for confirming that product design, use, and maintenance comply with laws, regulations, codes, and mandatory standards applied where the product is used.

### Technical Service & Replacement Parts

For answers to questions not addressed in these instructions and to order replacement parts, labels, and accessories, call our Technical Service and Parts Department at (260) 665-7586. The Department can also be contacted online at <https://www.vestil.com/page-parts-request.php>.

### Electronic Copies of Instruction Manuals

Additional copies of this instruction manual may be downloaded from <https://www.vestil.com/page-manuals.php>.

<b>Table of Contents</b>		<b>Page</b>
Signal Words.....		2
Safety Instructions.....		2
FIG. 1: Exploded View and Bill of Materials.....		2
Specifications.....		3
Installing the Bollard.....		4
FIG. 2: Sleeve with Drain Tube.....		4
FIG. 3: Ground Preparations.....		4
FIG. 4: Install Cap.....		4
FIG. 5A: Install Bollard.....		4
FIG. 5B: Top View of Sleeve.....		4
Inspections.....		4
Limited Warranty.....		5

## SIGNAL WORDS

This manual uses SIGNAL WORDS to indicate the likelihood of personal injuries, as well as the probable seriousness of those injuries, if the product is misused in the ways described. Other signal words call attention to uses of the product likely to cause property damage. The following are signal words used in this manual and their definitions.

<b>⚠ DANGER</b>	Identifies a hazardous situation which, if not avoided, <b>WILL</b> result in <b>DEATH</b> or <b>SERIOUS INJURY</b> . This signal word is limited to the most extreme situations.
<b>⚠ WARNING</b>	Identifies a hazardous situation which, if not avoided, <b>COULD</b> result in <b>DEATH</b> or <b>SERIOUS INJURY</b> .
<b>⚠ CAUTION</b>	Indicates a hazardous situation which, if not avoided, <b>COULD</b> result in <b>MINOR</b> or <b>MODERATE</b> injury.
<b>NOTICE</b>	Identifies practices likely to result in product/property damage, such as operation that might damage the product.

## SAFETY INSTRUCTIONS

Vestil strives to identify all hazards associated with the use of our products. However, material handling is dangerous and no manual can address every risk. The most effective way to avoid injury is for the end-user to exercise sound judgment whenever using this product.

### ⚠ WARNING

Improper or careless operation might result in serious personal injuries or death.

- Read the entire manual before assembling, installing, using, or servicing the table. A copy of this manual must be available at all times to persons who assemble, install, use, or service the table. Read the manual whenever necessary to refresh your understanding of use and maintenance procedures.
- DO NOT attempt to install the bollard without assistance if you cannot comfortably lift and control it. Determine the net weight of the bollard from the "Product Specifications" table below.
- DO NOT modify the bollard or sleeve. Modifications might make the bollard unsafe to use and automatically void the [LIMITED WARRANTY](#) on p. 5.
- Electrocutation might result if any part of the bollard or the sleeve contacts electrified wires. Avoid contact with electrified wires while digging the installation hole. DO NOT contact live electrical wires, buried cables, or underground gas lines while installing the bollard. Determine the locations of all underground utility lines BEFORE beginning to dig the hole for the bollard sleeve. Choose a location that is at least 3 feet away from all underground lines on all sides.

## FIGURE 1: EXPLODED VIEW AND BILL OF MATERIALS

23-007-207

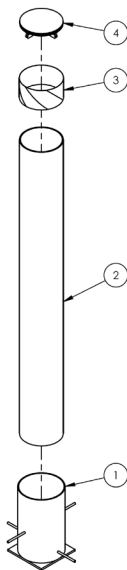

ITEM	PART NO.	DESCRIPTION	QTY.
1	23-514-077	WELDMENT, FRAME, SLEEVE	1
2	23-024-159	GUARD, BOLLARD PIPE	1
	23-024-160	BOL-R-36-5.5	
	23-024-161	BOL-R-42-5.5	
	23-024-425	BOL-R-48-5.5	
3	99-134-366	LABEL, CAUTION 19"L x 3"H BLACK & CLEAR STRIP	1
4	23-024-328	GUARD, REMOVABLE BOLLARD CAP	1

# SPECIFICATIONS

Documents that provide specifications for BOL-R series bollards are available online to anyone who visits Vestil's website. Specifications include dimensions, net weight, and capacity information. To access the appropriate specifications document, navigate to the BOL-R webpage at <https://www.vestil.com/product.php?FID=672>. Scroll the page to the entry for the specific model you purchased. Click the button in the "PDF" column that looks like a pencil inside a blue-bordered box. A PDF file will open. This file is the specifications document. Print a copy of the document and keep it with your copy of this manual. If your model is not included on the [BOL-R webpage](#), or if you cannot access and/or print the specifications document, contact the [TECHNICAL SERVICE DEPT.](#) Contact information for the department is provided on the cover page of this manual. The following is an exemplar specifications document.

**NOTE:** 1IN. = 2.54CM; 1KG = 2.2 LB.

## REMOVABLE BOLLARD - BOL-R-36-5.5

APPROX WEIGHT: 39.14 lbs.  
DOES NOT INCLUDE WEIGHT OF POWER OR PACKAGING!!!

\*\*\*ANY ADDITIONS, DELETIONS, OR OMISSIONS MUST BE CORRECTED ON THIS DRAWING AS THIS DRAWING WILL BE CONSIDERED ALL INCLUSIVE\*\*\*

REMOVABLE BLACK TOP CAP

BLACK & YELLOW SAFETY STRIPES

GROUND LEVEL

DRAIN TUBE HOLE

FOR INTERNAL USE ONLY PROJECT SIGN OFF	
SALES	
ENG.	
FAB.	
POWER	

ALL GRAPHICS PROVIDED ARE FOR REFERENCE ONLY. IF CERTAIN DIMENSIONS ARE CRITICAL PLEASE VERIFY THOSE DIMENSIONS WITH YOUR SALESPERSON

DIMENSION TOLERANCE +/- 1/4

**STANDARD FEATURES**

MODEL NUMBER IS BOL-R-36-5.5

BOLLARD DIAMETER:  $\phi 5.9/16"$

OVERALL HEIGHT IS 46 3/4"

USABLE HEIGHT IS 36 3/4"

OVERALL WIDTH: 12"

SLEEVE BASE: 6"W x 6"L

SLEEVE HEIGHT: 10"

TOUGH BAKED IN POWDER COATED YELLOW FINISH

BLACK & YELLOW SAFETY STRIPES

ALL STEEL CONSTRUCTION (ASTM A-36 MIN.) WITH WELDING TO MEET AWS

WARNING: CHECK APPLICABLE STATE & LOCAL LAWS FOR YOUR AREA

**SPECIAL FEATURES**

NONE

**A P P R O V A L**

I, THE UNDERSIGNED, AGREE THAT THE PRODUCT AS REPRESENTED SATISFIES DESIGN AND DIMENSION REQUIREMENTS. I ALSO ACKNOWLEDGE MY DUTY TO CONFIRM PRODUCT AND INSTALLATION COMPLIANCE WITH ALL APPLICABLE FEDERAL, STATE AND LOCAL REGULATIONS AND STANDARDS.

**ANY MODIFIED UNITS ARE NON-RETURNABLE**

[ ] As drawn [ ] As marked

Signed: \_\_\_\_\_ Date: \_\_\_\_\_

Printed Name: \_\_\_\_\_

LEAD TIME WILL START UPON RECEIPT OF SIGNED APPROVAL DRAWING

DISTRIBUTOR'S NAME: <b>VESTIL MANUFACTURING</b>		P.O.# X
DRAWN BY: TJM		W.O.# X
DATE: 04/10/14	SCALE: 1:12	SALES: X
REFERENCE: X	QUOTE # X	FILE NAME: 23-007-207
QUOTED LEAD TIME: X		

## INSTALLING THE BOLLARD

**Step 1:** Refer to [FIG. 2](#). To prevent water from collecting in the sleeve, use a 10–12in. (25–30cm) piece of 1½ in. outer diameter PVC tube to function as a drain pipe. Insert the tube into the drain hole in the bottom of the sleeve. The top of the tube should be approximately flush with the top of the bottom plate of the sleeve. Affix the drain tube to the sleeve with silicone adhesive. Allow the adhesive to dry before proceeding to step 2.

**FIG. 2:** Sleeve with drain tube

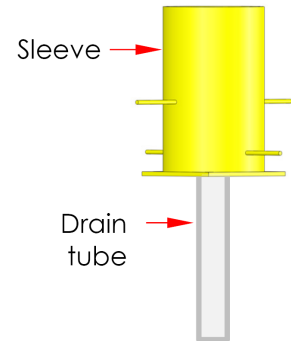

**Step 2:** Dig a 20 inch x 20 inch hole (~51cm x 51cm) approximately 24 inches deep (61cm) to contain the concrete. Center the hole on the location where you wish to install the bollard. Fill the bottom of the hole with ~12 inches of gravel and then set the sleeve in the center of the hole. Press the PVC drain into the gravel until the top of the sleeve is slightly above ground level. See [FIG. 3](#).

**Step 3:** Partially fill the hole with 3,000psi compression rated concrete into the hole; stop filling when the surface of the concrete is a few inches below the top of both the sleeve and the hole. Check the vertical levelness of the sleeve. Adjust the position of the sleeve if necessary. DO NOT get concrete inside the sleeve. Allow the concrete to cure according to the instructions that accompany the concrete mixture.

**Step 4:** Press the rubber cap into the opening at the top of the bollard. See [FIG. 4](#).

**Step 5:** Lower the bollard into the sleeve. See [FIGS. 5A & 5B](#). Press the bollard down until it contacts the bottom of the sleeve.

**FIG. 3:** Ground preparations

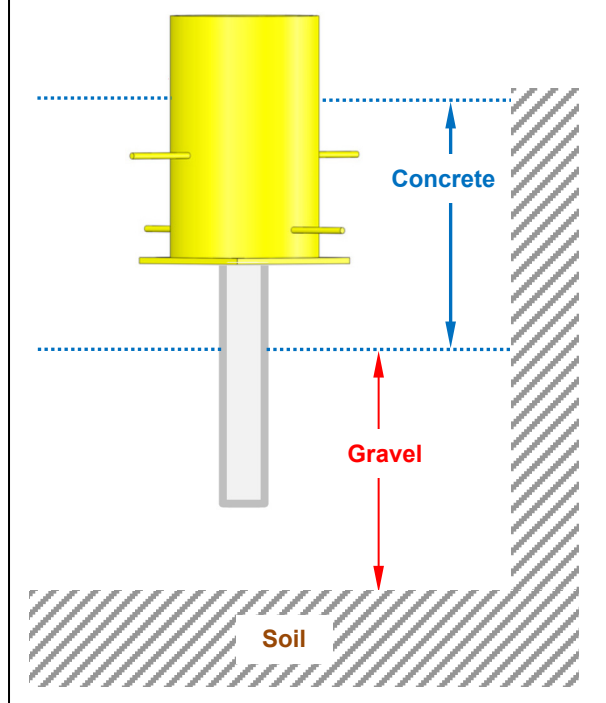

**FIG. 4:** Install the cap

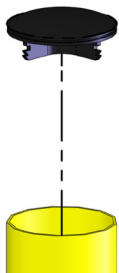

**FIG. 5A:** Install bollard

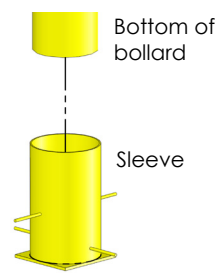

**FIG. 5B:** Top view of sleeve

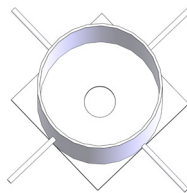

## INSPECTIONS

Regular maintenance is essential for maximizing the service life of this product. At least once per month, remove the bollard from the sleeve. Examine the bollard, particularly the bottom portion. Remove rust/corrosion and apply touchup paint wherever the finish/paint is damaged. Inspect the inside of the sleeve for rust and other forms of damage. Remove rust. A thin layer of oil can be applied to the inside of the sleeve.

DON'T GUESS! Contact [TECHNICAL SERVICE](#) if you have questions that are not addressed in these instructions or if you are uncertain how to address an issue discovered during an inspection. Technical Service can be contacted by calling (260) 665-7586 and asking for the Service and Parts Department or by submitting your questions through Vestil's online parts and service portal at <https://www.vestil.com/page-parts-request.php>.



## LIMITED WARRANTY

Vestil Manufacturing Corporation ("Vestil") warrants this product to be free of defects in material and workmanship during the warranty period. Our warranty obligation is to provide a replacement for a defective, original part covered by the warranty after we receive a proper request from the Warrantee (you) for warranty service.

### Who may request service?

Only a warrantee may request service. You are a warrantee if you purchased the product from Vestil or from an authorized distributor AND Vestil has been fully paid.

### Definition of "original part"?

An original part is a part used to make the product as shipped to the Warrantee.

### What is a "proper request"?

A request for warranty service is proper if Vestil receives: 1) a photocopy of the Customer Invoice that displays the shipping date; AND 2) a written request for warranty service including your name and phone number. Send requests by one of the following methods:

<u>US Mail</u>	<u>Fax</u>	<u>Email</u>
Vestil Manufacturing Corporation 2999 North Wayne Street, PO Box 507 Angola, IN 46703	(260) 665-1339 <u>Phone</u> (260) 665-7586	<a href="mailto:info@vestil.com">info@vestil.com</a> Enter "Warranty service request" in the subject field.

In the written request, list the parts believed to be defective and include the address where replacements should be delivered. After Vestil receives your request for warranty service, an authorized representative will contact you to determine whether your claim is covered by the warranty. Before providing warranty service, Vestil will require you to send the entire product, or just the defective part (or parts), to its facility in Angola, IN.

### What is covered under the warranty?

The warranty covers defects in the following original, dynamic parts: motors, hydraulic pumps, motor controllers, and cylinders. It also covers defects in original parts that wear under normal usage conditions ("wearing parts"), such as bearings, hoses, wheels, seals, brushes, and batteries.

### How long is the warranty period?

The warranty period for original dynamic components is 90 days. For wearing parts, the warranty period is 90 days. Both warranty periods begin on the date Vestil ships the product to the Warrantee. If the product was purchased from an authorized distributor, the periods begin when the distributor ships the product. Vestil may, at its sole discretion, extend a warranty period for products shipped from authorized distributors by up to 30 days to account for shipping time.

### If a defective part is covered by the warranty, what will Vestil do to correct the problem?

Vestil will provide an appropriate replacement for any covered part. An authorized representative of Vestil will contact you to discuss your claim.

### What is not covered by the warranty?

The Warrantee (you) is responsible for paying labor costs and freight costs to return the product to Vestil for warranty service.

### Events that automatically void this Limited Warranty.

- Misuse;
- Negligent assembly, installation, operation or repair;
- Installation/use in corrosive environments;
- Inadequate or improper maintenance;
- Damage sustained during shipping;
- Collisions or other accidents that damage the product;
- Unauthorized modifications: Do not modify the product IN ANY WAY without first receiving written authorization from Vestil.

### Do any other warranties apply to the product?

Vestil Manufacturing Corp. makes no other express warranties. All implied warranties are disclaimed to the extent allowed by law. Any implied warranty not disclaimed is limited in scope to the terms of this Limited Warranty. Vestil makes no warranty or representation that this product complies with any state or local design, performance, or safety code or standard. Noncompliance with any such code or standard is not a defect in material or workmanship.